

42-HR-2

CUTTING ARM

35-2543

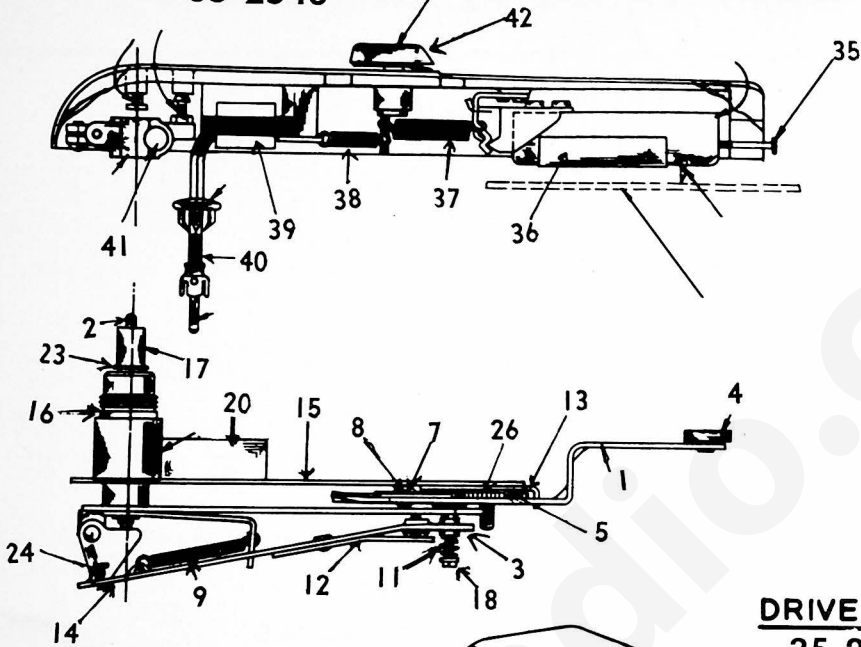

DRIVE UNIT

35-2542

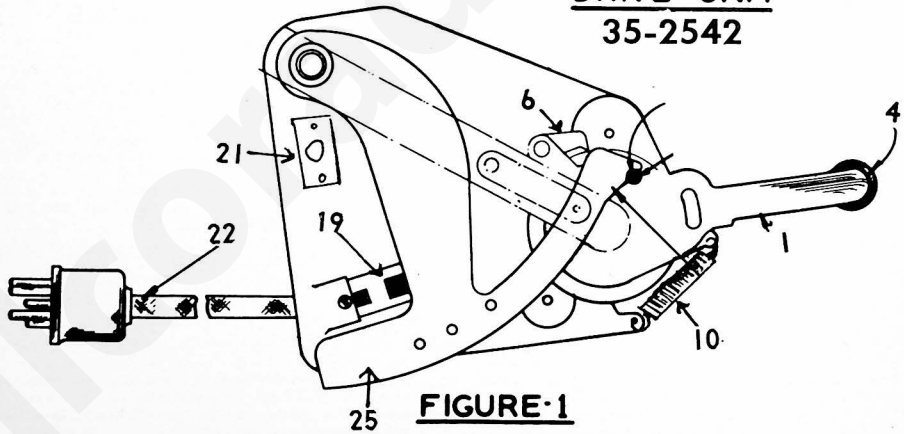

FIGURE 1

REPLACEMENT PARTS

No.	Description	Part No.	No.	Description	Part No.	No.	Description	Part No.
1	Pawl Lever	56-2410	16	Main Shaft Bearing	56-6176	30	Shoulder Rivet	57-2156
2	Push Rod	56-2413	17	Main Shaft	56-6177	31	Large Size Mtg. Nut	W-2295
3	Drive Pulley	56-6178	18	Drive Wheel Stud	56-6181	32	Mtg. Washer	W-2294
4	Idler Roller	56-6179	19	Switch	42-1716	33	Locking Sleeve	56-6183
5	Ratchet Wheel	56-2408	20	Switch Cover	56-1421	34	Locking Nut	56-6194
6	Pawl	56-2412	21	Socket and Plug Assembly	27-6186	CUTTING ARM		
7	Pawl Spring	28-8997	22	Cord and Plug Assembly	41-3639	35	Needle Screw	(56-6182)
8	Pawl Lever Spring	28-8997	23	Main Shaft "C" Washer	57-1378	36	Cartridge Assembly	76-1413
9	Push Rod Spring	28-8996	24	Groove Pin	W-2291	37	Spring	28-8992
10	Ratchet Plate Spring	28-8995	25	Sector	56-2409	38	Spring	28-8998
11	Clutch Tension Spring	28-8995	26	Clutch Plate	56-2446	39	Transformer	32-8208
12	Indexing Spring	56-2407	27	Clutch Washer	27-9996	40	Cable and Plug Assembly	41-3656
13	Ratchet Plate	56-2405	MISCELLANEOUS PARTS			41	Female Hinge and Pivot Assembly	76-1414
14	Throw Out Bar	56-2414	28	Shoulder Rivet	W-2290	42	Knob, Spring, Set Screw Assembly	76-1419
15	Main Plate	56-2411	29	Rivet	W-207	43	Neon Indicator	34-2493